

End Launch Connectors

FPELC-K-1

2.92mm, DC~40GHz

Features:

- Low VSWR
- No welding
- Reusable
- Easy installation

Applications:

- Laboratory Test

Electrical

Frequency	DC-40GHz
VSWR	1.25 max.
Impedance	50Ω

Mechanical

RF Connector	2.92mm
Outer Conductor	Passivated stainless steel
Dielectric	PEI & PTFE
Inner Conductor	Gold plated beryllium copper

Environmental

Temperature	-55 ~ +165°C
-------------	--------------

Outline Drawings

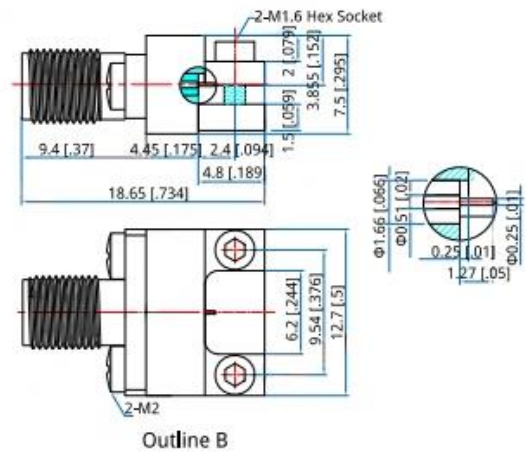
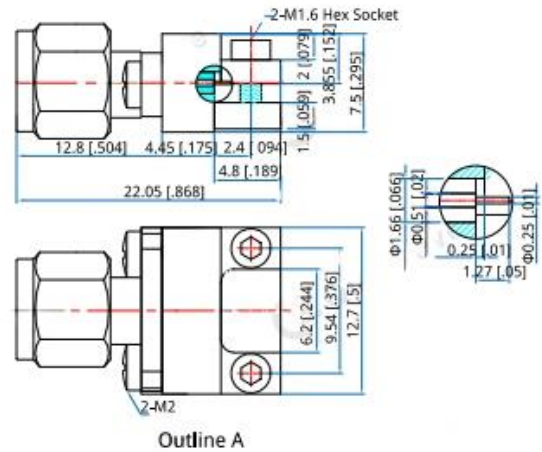

PCB Layout

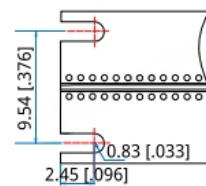

Unit: mm [in]

Tolerance: ±0.2mm [±0.008in]