

End Launch Connectors

FPELC-K-3

2.92mm, DC~40GHz

Features:

- Low VSWR
- No welding
- Reusable
- Easy installation

Applications:

- Laboratory Test

Electrical

| | |
|-----------|-----------|
| Frequency | DC-40GHz |
| VSWR | 1.25 max. |
| Impedance | 50Ω |

Mechanical

| | |
|-----------------|------------------------------|
| RF Connector | 2.92mm |
| Outer Conductor | Passivated stainless steel |
| Dielectric | PEI & PTFE |
| Inner Conductor | Gold plated beryllium copper |

Environmental

| | |
|-------------|--------------|
| Temperature | -55 ~ +165°C |
|-------------|--------------|

Outline Drawings

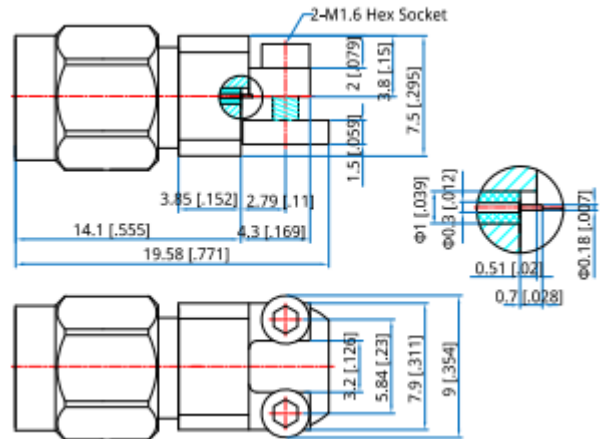

Outline A

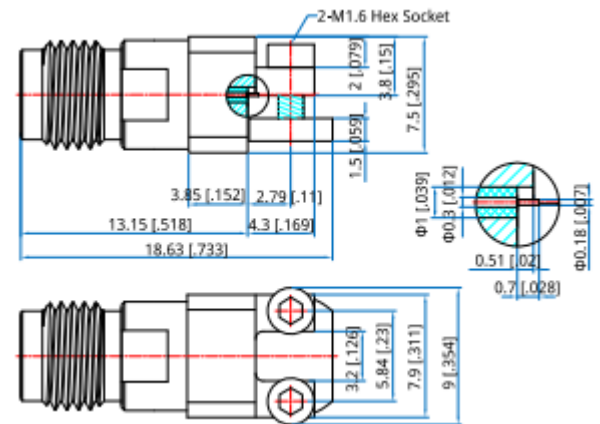

Outline B

Unit: mm [in]

Tolerance: ±5% ±0.2mm [±0.008in](Screw sleeve)